

Class 2  
OTC Medicine

For severe pains in your shoulders, lower back, and joints

# LOXONIN<sup>®</sup>S Hard Gel

## Characteristics of LOXONIN S Hard Gel

Contains [loxoprofen sodium hydrate] with excellent anti-inflammatory and analgesic effects.

- The stick-type hard gel can be applied over a wide area without getting your hands messy and it works well.
- Low odor, translucent, and discreet type
- Goes on smoothly and is non-sticky, so you can wear clothes over the affected area right after application.



## Precautions



### Things to avoid

(If you fail to follow these precautions, your present symptoms may worsen, or side effects may occur more readily.)

#### 1. This product should not be used by the following persons.

- (1) Persons who have experienced allergic symptoms to this product or the ingredients contained in it in the past.
- (2) ~~Persons who have experienced asthma after using this product or other antipyretic analgesics, cold medicines, or topical anti-inflammatory analgesics.~~
- (3) Children under the age of 15

#### 2. Please avoid applying to the following parts.

- (1) Around eyes, mucous membranes etc.
- (2) Delicate skin (face, armpits, etc.)
- (3) Skin with rashes, skin irritations, or wounds
- (4) Athlete's foot, ringworm infections, or other infected areas

#### 3. Please do not use other topical anti-inflammatory analgesics while using this product.

#### 4. Do not use this product continuously for more than 2 weeks.

(This product is intended to temporarily relieve pain. If pain or other symptoms persist, stop using it, and consult a doctor.)



### Things to consult

#### 1. The following persons should consult a doctor, pharmacist, or registered seller before use.

- (1) Persons undergoing medical treatment from a doctor.
- (2) Persons who have had allergic symptoms to medicines or such.
- (3) ~~Women who are pregnant or are considered to be pregnant.~~
- (4) Elderly people
- (5) Persons with the following diagnoses: Bronchial asthma

#### 2. If the following symptoms are observed after using this drug, these may be adverse reactions, so stop using the medicine immediately and bring this instruction to a consultation with your doctor or pharmacist, or registered seller.

Related Part	Symptoms
Skin	Rash, redness, itching, Swelling, tingling, contact dermatitis, blisters, hyperpigmentation
Digestive organs	Stomach discomfort, pain in the solar plexus
Other	Oedema

In rare cases, the following severe symptoms may occur. If they do occur, immediately consult with your doctor.

Symptom Names	Symptoms
Shock (anaphylaxis)	Symptoms such as itchy skin, hives, hoarse voice, sneezing, itchy throat, shortness of breath, palpitations, or impaired consciousness may appear immediately after use.

#### 3. The following symptoms may appear, but if any of these symptoms persist or increase, discontinue use, and bring this instruction to a consultation with a doctor, pharmacist, or registered seller. Diarrhea, loose stool

#### 4. If symptoms do not improve after taking the product for 5 or 6 days, discontinue use and bring this instruction to a consultation with a doctor, pharmacist, or registered seller. (There may be other potential diseases)

## Indications

Lower-back pain, shoulder pain associated with stiff shoulders, joint pain, muscle pain, tendonitis (hand/wrist pains), elbow pain (tennis elbow, etc.), bruises, sprains

## Dosage and Administration

Apply an appropriate amount to the affected area 3 to 4 times a day.

### <Precautions related to dosage and administration>

- (1) Follow the dosage and administration strictly.
- (2) Do not cover the area where this product was applied with plastic wrap or other materials with low air permeability.
- (3) This product is intended to relieve symptoms such as pain or swelling. It is not intended to cure the causes of pain or swellings. Therefore, apply this product only when symptoms appear.
- (4) Do not apply more than about 2g (application area: about 10 times the size of the palm of the hand) per application, or 50g per week.
- (5) Avoid getting the product into the eyes. If you got it in your eye(s), wash your eye(s) immediately with water or lukewarm water. If symptoms are severe, please consult with your ophthalmologist.
- (6) This product is for external use only.
- (7) If the affected area is wet or is sweaty, dry thoroughly before use.
- (8) Dispense 3 to 4mm of the gel first to avoid direct contact between the container and the affected area.
- (9) When the saucer at the bottom of the container becomes visible and starts to loosen, please stop using the product. Also, do not use force to extract the remaining product.

### <How to Use the Container>

1. Remove the top cap.

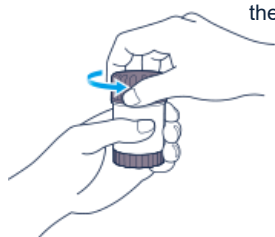

2. Turn the dial on the bottom to the right to expose 3-4mm of the hard gel.



3. Apply an appropriate amount by pressing it against the affected area.

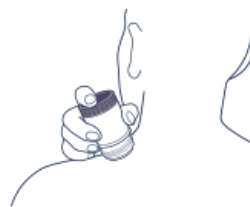

4. After use, turn the dial to the left to retract the medicine and close the cap.

## Ingredients and Quantities

The product containing the following ingredients per 100 g.

Ingredient	Quantity	Effect
Loxoprofen sodium hydrate	1.13 g (1 g as anhydride)	Suppresses 【prostaglandin】 , the source of inflammation and pain.

Additives: Sodium stearate, Macrogol stearate, Polyoxyethylene Hydrogenated Castor Oil, Sodium hydroxide, Ethanol

## Storage and Handling Precautions

- (1) Tightly close the container and store it in a cool place out of direct sunlight.
- (2) Since the product readily evaporates, please close the cap after use to prevent constant exposure to air.
- (3) Store out of reach of children.
- (4) Don't put it in a different container. (It can lead to misuse or a lowering of quality.)
- (5) Keep away from fire.
- (6) This product may dissolve chemical fibers, plastics, and painted surfaces. Therefore, avoid getting it in contact with floors, furniture, glasses, etc.
- (7) Please do not use medicine after the expiration date. It is recommended to use the product shortly after opening.

If you have any questions about this product,  
please contact the store where you purchased it or at the following address:

**Daiichi Sankyo Healthcare Co., Ltd. Customer Relations Office**

3-14-10, Nihonbashi, Chuo-ku, Tokyo, Japan zip/postal code 103-8234

TEL: 0120-337-336 Reception Hours: 9:00 am -5:00 pm (Closed Saturday, Sunday, and holidays)

<https://www.daiichisankyo-hc.co.jp/>

01®registered trademark



Manufacturer and seller

**Daiichi Sankyo Healthcare Co., Ltd.**

3-14-10, Nihonbashi, Chuo-ku, Tokyo, Japan