

Eye Wash for Relief from Pollen, House Dust, etc. Eye Cleaning after Removing Contact Lenses

AG Allercut® Fresh Eye
Class 3 OTC Medicine

Before using, be sure to read this written explanation on the package.
Also, please put it in a safe place so that you can read it when necessary.



Precautions



Things to consult

1. The following persons should consult a doctor, pharmacist, or registered seller before use.

- (1) Persons undergoing medical treatment from a doctor
- (2) Persons who have had allergic symptoms to medicines or such
- (3) Persons who have the following symptoms:
Severe eye pain

2. If the following symptoms are observed after using this product, these may be adverse reactions, so stop using the medicine immediately and bring this instruction on the package to a consultation with your doctor, pharmacist, or registered seller.

Related Part	Symptoms
Skin	Rash, redness, itching
Eyes	Bloodshot, itching, swelling

Ingredients and Quantities

Per 100 ml

Chlorpheniramine Maleate.....3mg

Dipotassium Glycyrrhizinate.....25mg

ε-Aminocaproic Acid.....150mg

Pyridoxine Hydrochloride (vitamin B₆)10mg

Taurine.....100mg

Additives: Boric Acid, Sodium Borate, Edetate Sodium, Glycerin, Propylene Glycol, Polysorbate 80, Benzalkonium Chloride Concentrated Solution 50, l-Menthol, dl-Camphor, d-borneol, pH adjuster

Storage and Handling Precautions

- (1) Store tightly closed in a cool place and out of direct sunlight.
- (2) Keep out of reach of children.
- (3) Don't put it in a different container. (It can lead to misuse or lowering of quality.)
- (4) Please do not share the eye wash cup with others.
- (5) Please do not use medicine after the expiration date.

<Contact us>

Daiichi Sankyo Healthcare Co., Ltd.
Customer Relations Office
3-14-10, Nihonbashi, Chuo-ku, Tokyo, Japan
zip/postal code 103-8234
TEL: 0120-337-336
Reception Hours: 9:00 am -5:00 pm (closed Saturday, Sunday, and holidays)

<https://www.daiichisankyo-hc.co.jp/>

MADE IN JAPAN



Daiichi-Sankyo

Seller
Daiichi Sankyo Healthcare Co., Ltd.
3-14-10, Nihonbashi, Chuo-ku, Tokyo, Japan

Indications

Eye cleansing, prevention of eye diseases (After swimming, when dust or sweat gets into your eyes, etc.)

Dosage and Administration

Use 3 to 6 times a day. Wash the eyes with 5 mL of this product each time.

<How to Use>

Fill the included eye wash cup with the eyewash solution up to the inner line (5mL) and press it firmly around your eye. Then, while keeping the cup pressed around your eye, tilt your head back to prevent spillage, look upward, and blink several times to wash the eye.

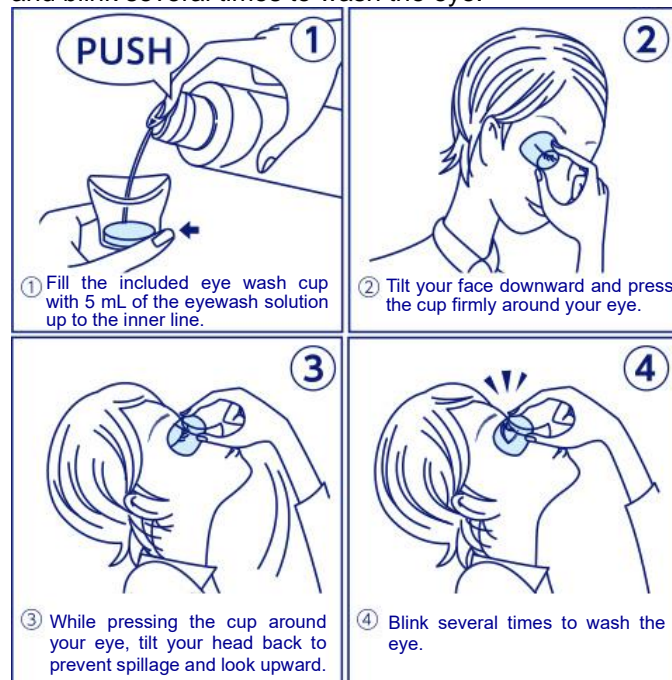

Do not wash the other eye with the same liquid used for one eye. Dispose of the liquid, thoroughly clean the eye wash cup with tap water, and then wash the other eye.

<Precautions related to dosage and administration>

- (1) Follow the Dosage and Administration strictly.
- (2) For children, please follow the guidance of a guardian when using this product.
- (3) Do not use this product while wearing contact lenses.
- (4) Please thoroughly clean the eye wash cup with tap water before and after use.
- (5) Do not use it if the solution is cloudy.
- (6) Use only for eye washing.
- (7) Please cleanse the area around the eyes and remove makeup thoroughly before use.

Contact for inquiries regarding "The Relief System for Sufferers from Adverse Drug Reactions"
Pharmaceutical and Medical Devices Agency (PMDA)
https://www.pmda.go.jp/kenkouhigai_camp/index.html
TEL: 0120-149-931 (Toll-Free)

01® Registered Trademark

Manufacturer and Seller
Nitto Medic Co., Ltd.
1-14-1, Yatsuomachi-yasuuchi, Toyama City, Toyama Prefecture